

ROUGE VALLEY QUILTERS' GUILD – BLOCK OF THE MONTH

FEBRUARY 2009 – HOUSE

The following directions will make one house block (unfinished 8 ½" X 8 ½", finished size 8" X 8"). For our strip quilt you will need three of these blocks but only bring one to the next meeting for the draw.

Suggestions for fabric choices. Colours are your choice and each house can be different if you wish.

The houses will be on the same quilt row as the trees you made in November, so try to have the same sky fabric that you used in the tree blocks. The houses look best when there is a good contrast between the gable and the house walls. Also, aim for good contrast between the walls and the door & window fabric.

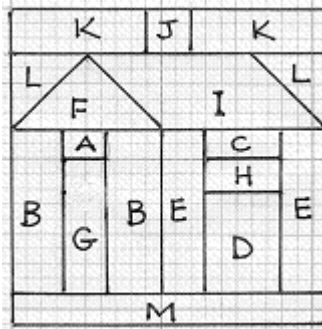

For each house you will need the following:

	Pieces	Number of pieces	Size
HOUSE WALLS	A	One	1 ½" X 1 ¾" rectangle
	B	Two	1 7/8" X 4 ½" rectangles
	C	One	1 ½" X 2 ½" rectangle
	D	One	2 ½" square
	E	Two	1 ½" X 4 ½" rectangles
GABLE	F	One	5 ¼" square, cut diagonally in both directions. Use one triangle per house.
DOOR	G	One	1 ¾" X 3 ½" rectangle
WINDOW	H	One	1 ½" X 2 ½" rectangle
ROOF	I	One	Parallelogram cut from 2 ½" strip. See diagrams.
CHIMNEY	J	One	1 ½" square
SKY	K	Two	1 ½" X 4" rectangles
	L	One	2 7/8" square cut in half diagonally to make two triangles
GROUND	M	One	1 ½" X 8 ½" rectangle

NOTE: A - E (walls) are all the same fabric/colour

ROOF/SKY: (1) Cut a 45 degree angle on the left of the 2 ½" strip (I). Place 3 1/4" mark on ruler on the angle cut and cut to make a parallelogram (see diagram).

(2) Stitch the gable piece (F) to the roof piece (see diagram). Press seam allowance towards roof.

(3) Stitch the long edge of a sky triangle (L) to one side of the roof and the long edge of the other sky triangle (L) to the gable end of the roof. Press seam allowances towards sky and trim points.

(4) Stitch the sky pieces (K) to either side of the chimney piece (J)

WALLS/DOOR/WINDOW: (1) Stitch wall piece (A) to top of door piece (G). Add wall pieces (B) to either side of the pieced door section.

(2) Stitch wall piece (C) to top of window piece (H) and add the wall piece (D) below the window.

Add the wall pieces (E) to either side of the pieced window section.

FINAL CONSTRUCTION: Join the pieced door section to the left of the pieced window section.

Add the sky/chimney piece to the top of the roof then join this to the main house section. Add the ground strip (M) to the bottom of the house.

Press the block and add your name.

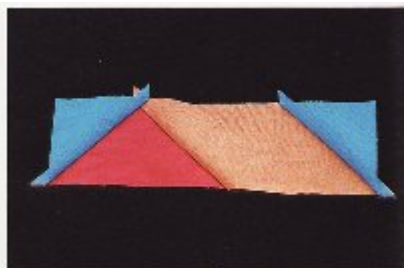
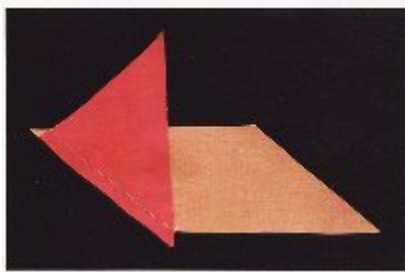

Pattern based on one in Singer Machine Quilted Projects and traditional patterns.