

# ROUGE VALLEY QUILTERS' GUILD BLOCK OF THE MONTH

SEPTEMBER 2008 – ATTIC WINDOWS

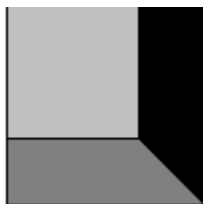

The following directions will make one block (finished size 6" X 6", unfinished 6 1/2" X 6 1/2").

For our strip quilt you will need six of these blocks. They can be all the same or made from different fabrics.

Fabric requirements:

One 4 1/2" square of light "window" fabric\*\*.

One 2 1/2" X 6 1/2" strip of medium fabric.

One 2 1/2" X 6 1/2" strip of dark fabric.

There should be a good contrast between the light, medium and dark fabrics.

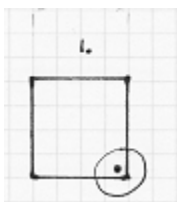

1. Mark a dot in the corner on the wrong side of the 4 1/2" square to indicate where the two 1/4" seam allowances will intersect.

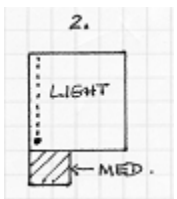

2. Pin the medium colour 2 1/2" X 6 1/2" strip to the square (right sides together) as shown. Sew a 1/4" seam allowance but stop at the dot with the needle down and take one or two back stitches.

3. Fold the medium strip away from the 4 1/2" square and press the seam allowance towards the strip.

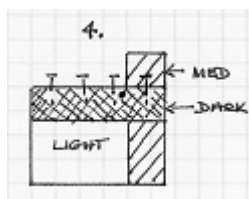

4. Place the block with right side facing you and pin the dark 2 1/2" X 6 1/2" strip in place as shown.

5. Flip over and sew just to the dot. Back stitch as before.

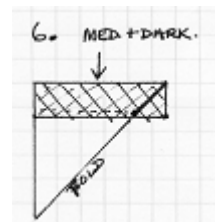

6. Fold the block at a 45 degree angle as shown. Make certain that the medium and dark strips are directly on top of one another. Draw a 45 degree line

from the dot to the corner of the strip. Sew exactly on this line, stopping at the dot and back stitching.

7. Trim away excess fabric and press the seam open. Your block should measure 6 1/2" X 6 1/2".

Do not join the blocks to one another at this time.

\*\*NOTE: Your window fabric must be the lightest of the three but you can choose any view e.g. sky, trees, mountains, lake, garden.

Pattern source: Traditional